

Queen Alexandra Hospital

Portsmouth Hospitals NHS Trust

The Hospital building has seven levels and is divided into Lift & Stairs Areas (1-8). Each level is colour coded.

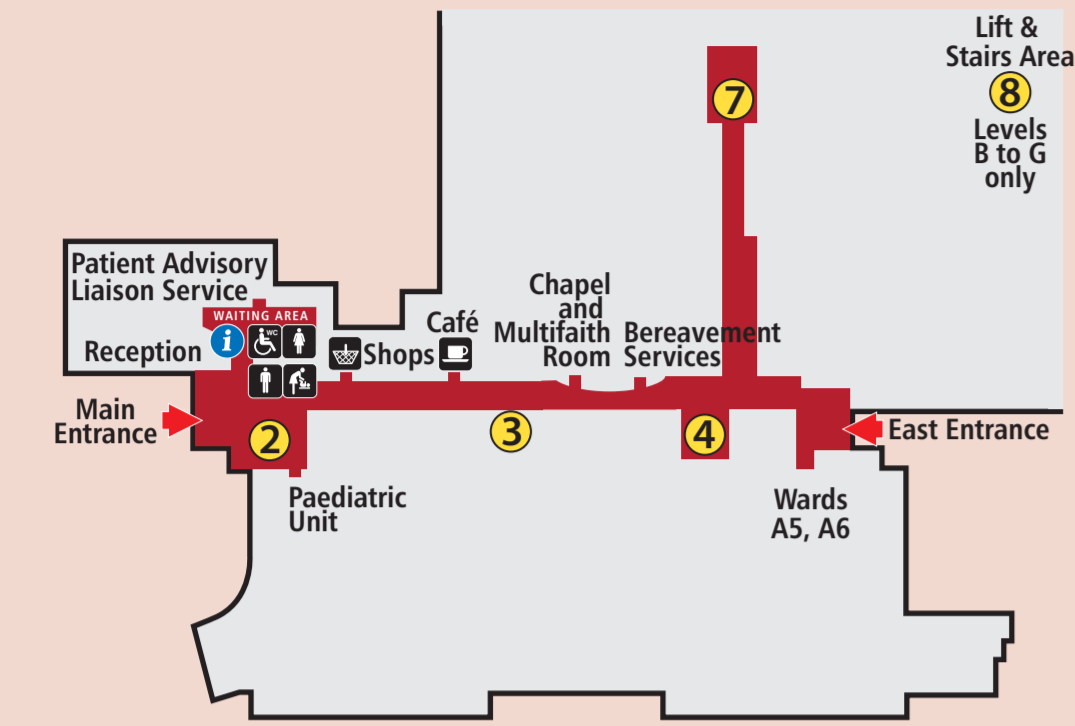

Level A

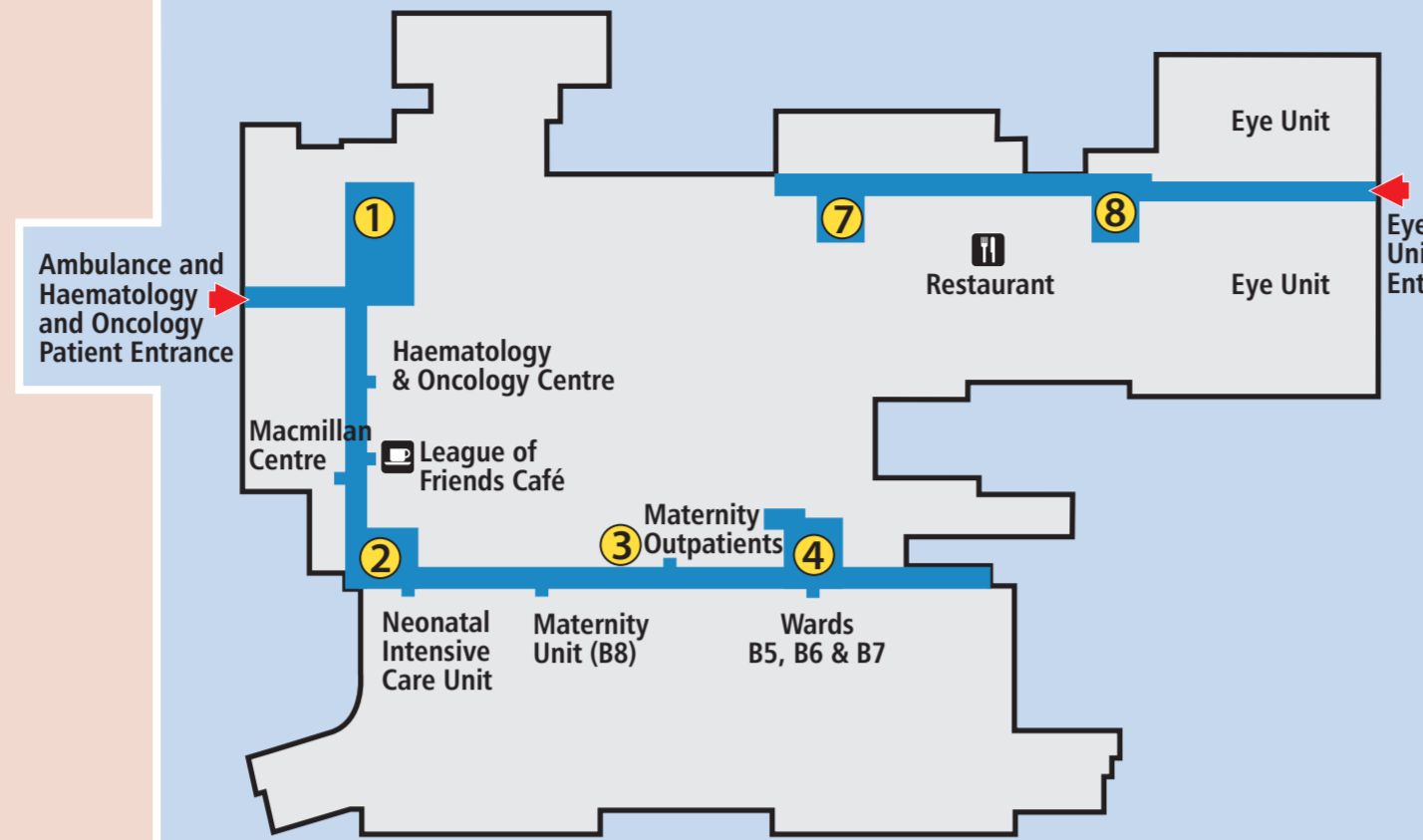

Level B

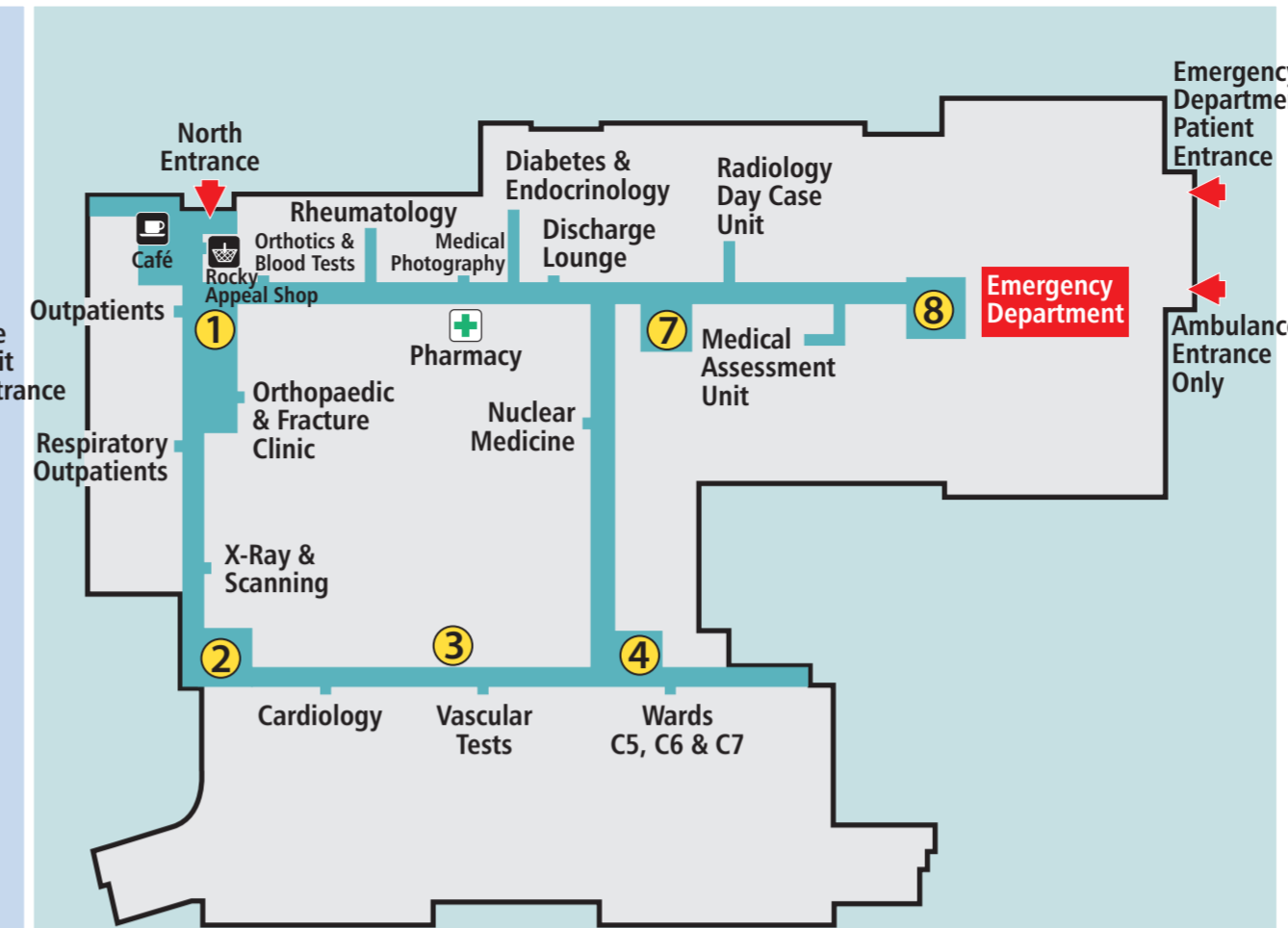

Level C

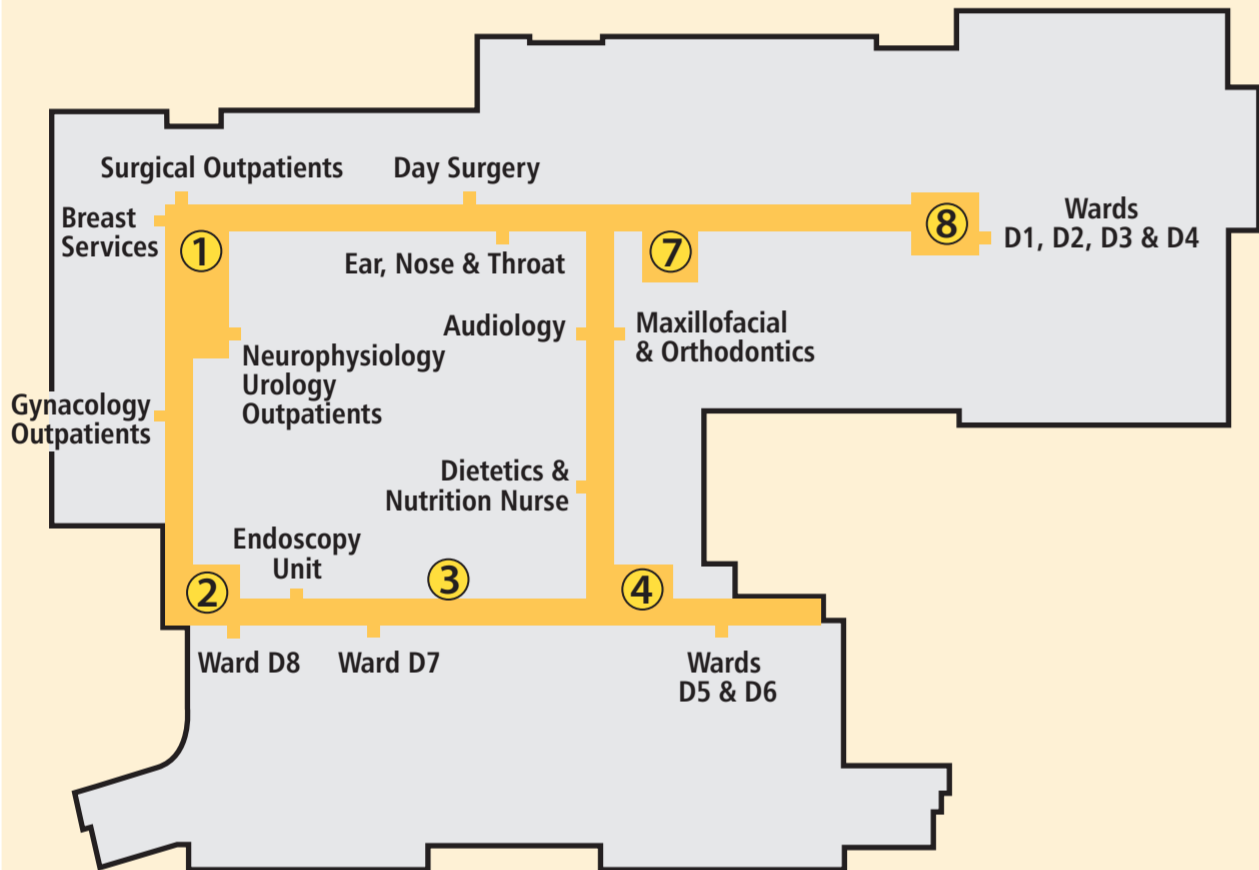

Level D

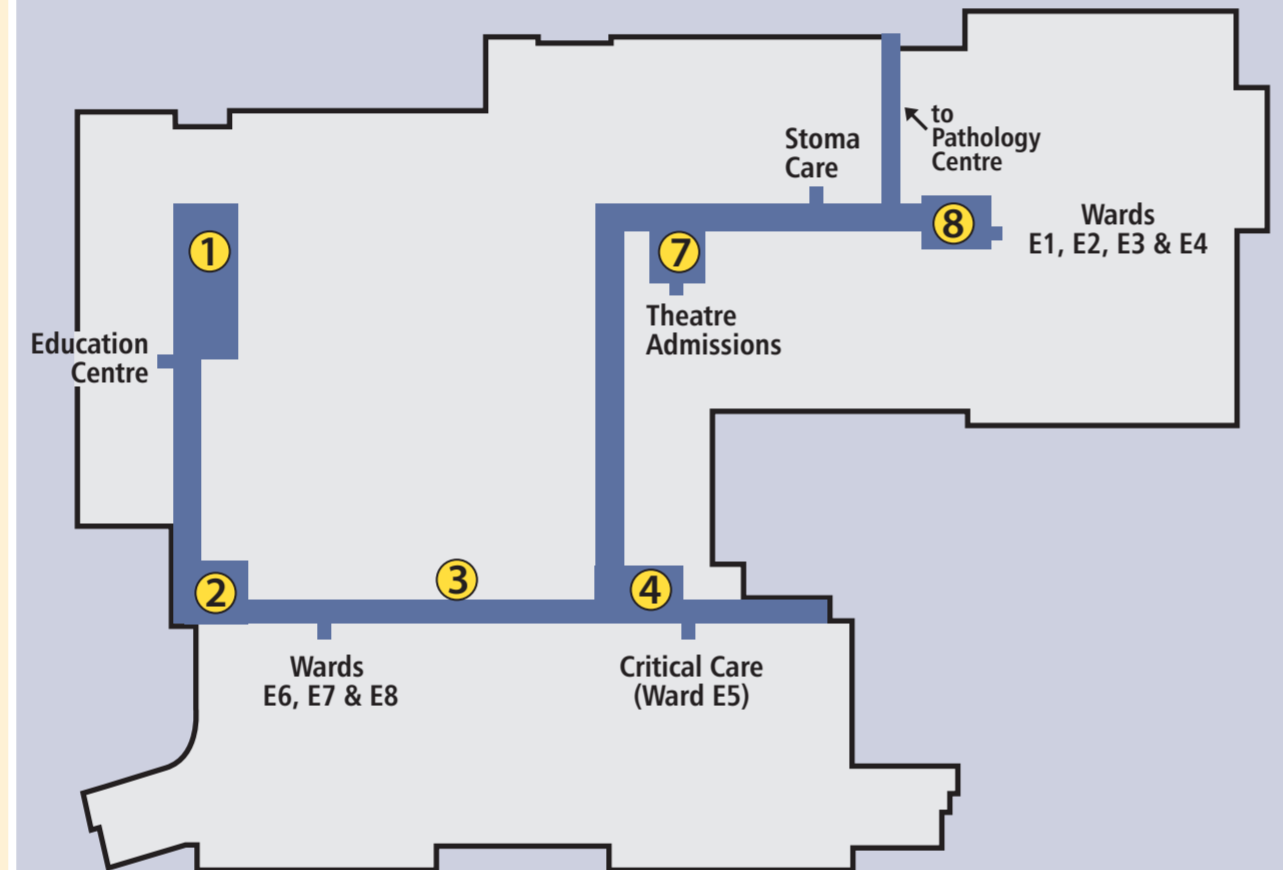

Level E

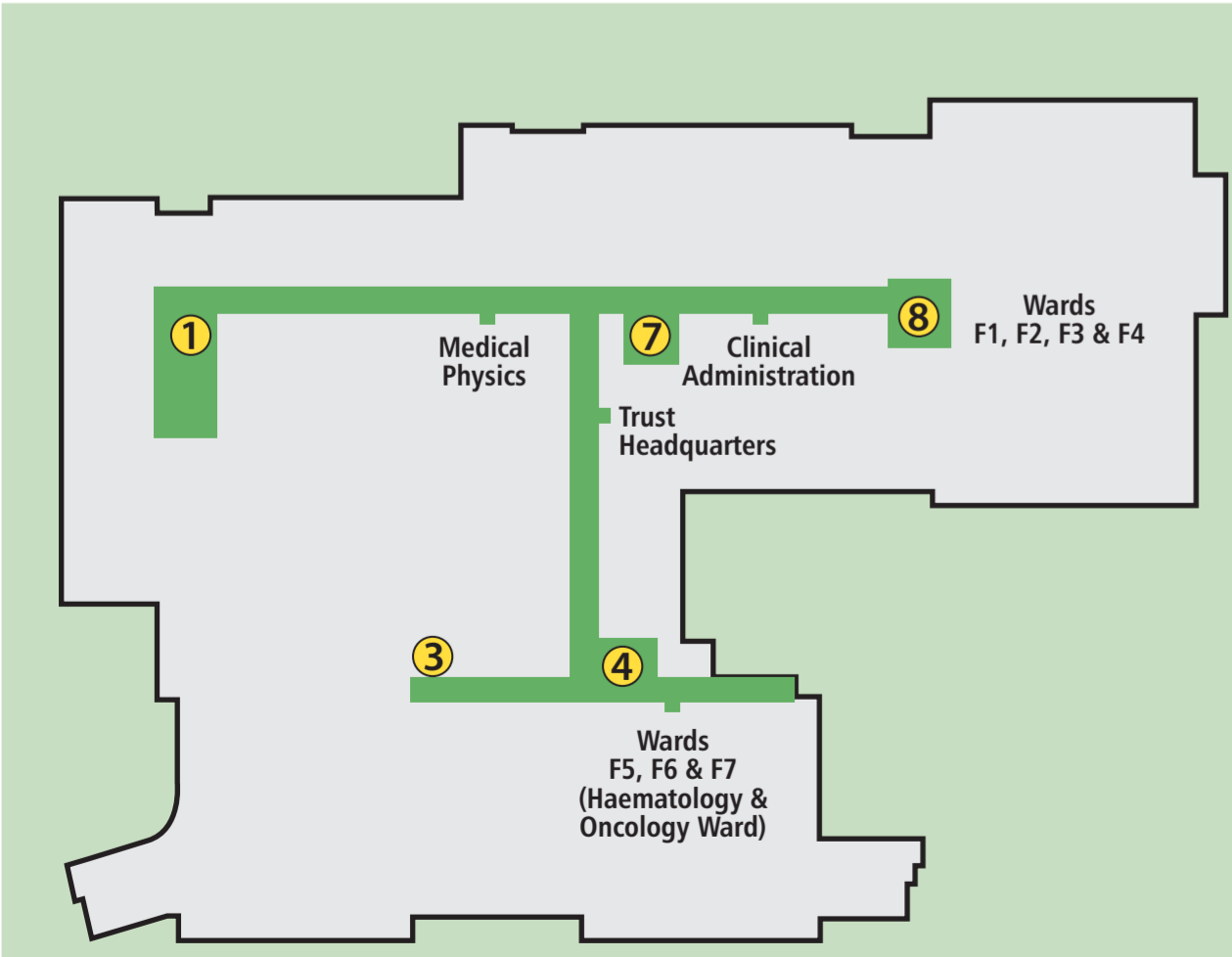

Level F

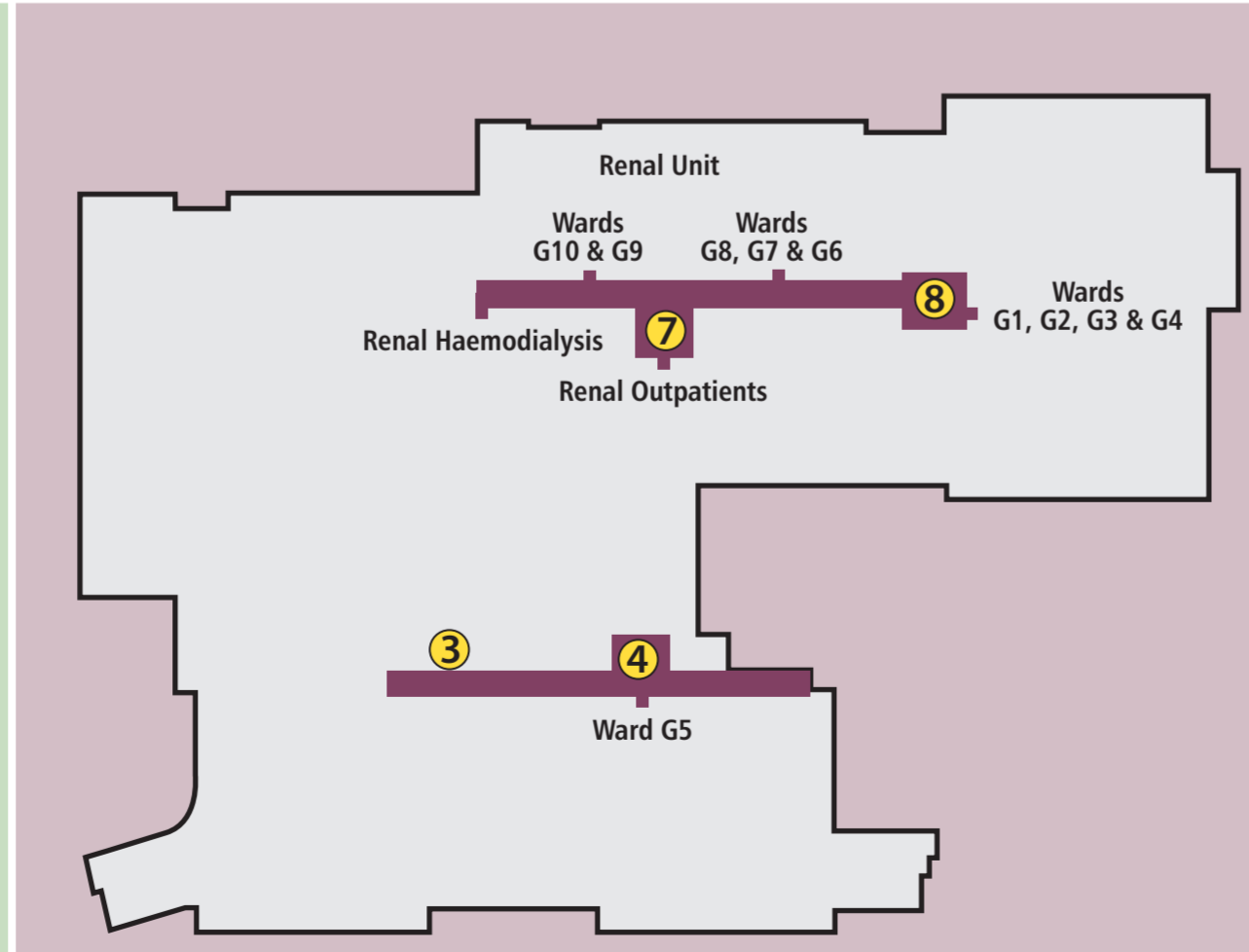

Level G

- Information
- Entrance
- Lift & Stair Area
- WC Male
- WC Female
- WC Disabled
- Baby Changing
- Café
- Restaurant
- Shop
- Pharmacy
- Patient & Visitor Car Parking
- Hospital
- Drop Off
- Bus Stop

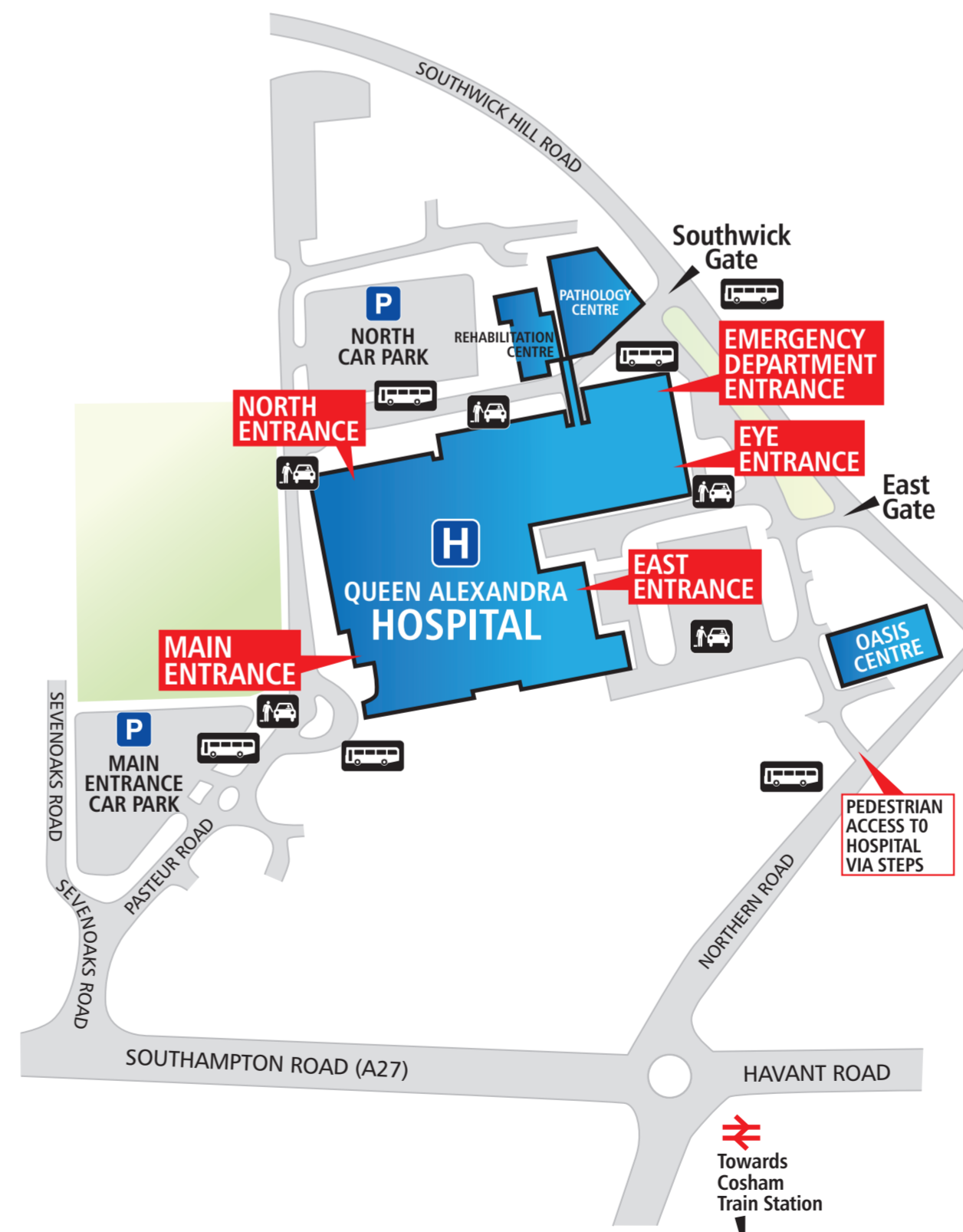

DISCLAIMER
The products and services advertised hereon should not be regarded as carrying the Trust's recommendation

© COPYRIGHT
PREMIER CONCEPTS
health media & design
Tel: 01666 829003

Ward / Department	Level	Car Park
A5, A6	A	East Entrance (Pay & Display)
Audiology	D	North
Bereavement Services	A	Main Entrance
Blood Tests	C	North
Breast Services	D	North
C5	C	Main Entrance
Café	A	Main Entrance
Café (League of Friends)	B	North
Café	C	North
Cardiology	C	Main Entrance
Chapel and Multifaith Room	A	Main Entrance
Critical Care (E5)	E	Main Entrance
D1, D2, D3, D4, D5, D6, D7, D8	D	Main Entrance
Day Surgery	D	Main Entrance
Diabetes and Endocrinology	C	North
Dietetics	D	Main Entrance
Discharge Lounge	C	North
E1, E2, E3, E4, E6, E7, E8	E	Main Entrance
Ear, Nose & Throat	D	North
Emergency Department	C	ED Entrance (Pay & Display) / North
Endoscopy Unit	D	Main Entrance
Eye Unit	B	North
F1, F2, F3, F4, F5, F6, F7	F	Main Entrance
G1, G2, G3, G4, G5	G	Main Entrance
Gynaecology Outpatients	D	North
Haematology and Oncology Centre	B	Main Entrance
Haematology and Oncology Ward	F	Main Entrance
Macmillan Centre	B	Main Entrance
Maternity Unit	B	Main Entrance
Medical Assessment Unit	C	ED Entrance (Pay & Display) / North
Medical Photography	C	North
Neonatal Intensive Care Unit	B	Main Entrance
Neurophysiology	D	North
Nuclear Medicine	C	North
Nutrition Nurse	D	Main Entrance
Orthodontics and Maxillofacial	D	North
Orthopaedic and Fracture Clinic	C	North
Orthotics	C	North
Outpatients	C	North
Paediatric Emergency Department	C	ED Entrance (Pay & Display) / North
Paediatric Unit	A	Main Entrance
Pathology Centre	E	North
Patient Advisory Liaison Service	A	Main Entrance
Pharmacy	C	North
Radiology Day Case Unit	C	North
Renal Unit	G	Main Entrance
Respiratory Outpatients	C	North
Restaurant	B	Main Entrance
Rheumatology Outpatients	C	North
Rocky Appeal Shop	C	North
Security	A	Main Entrance
Shop	A	Main Entrance
Stoma Care	E	North
Surgical Outpatients	D	North
Theatre Admissions	E	Main Entrance
Trust Headquarters	F	Main Entrance
Urology Outpatients	D	North
Vascular Tests	C	Main Entrance
X-Ray & Scanning	C	Main Entrance